

## FEATURE RECORD

F.S.U. St. Augustine Program

Site No. SA-26-1Date MAY 30 1979Sheet 3 of 3Feature No.: 50 Recorder CARALLASExcavation Units: TRENCH A SECTION 1Depth from Surface: 21 cmDepth from Datum: Top: 1.71  
Base: -

Definition: HOUSE FOUNDATION - 4 COQUINA BLOCKS  
W LIME MORTAR. MAMPOSTERIA CONSTRUCTION, EVIDENCE  
OF A WOODEN BEAM IN THE WESTERNMOST BLOCK. PM 1  
POSSIBLE 19th CENTURY. PINS ~~ARE~~ ~~IN~~ PERPENDICULARLY  
FROM CHARLOTTE STREET E-W LINE.

Matrix and Stratigraphy: MODERN FILL & RUBBLEUnderlies: LAYER OF DISTURBED MODERN FILL & RUBBLEIn Matrix of: MODERN FILL & RUBBLEIntrudes into: -Overlies: LAYER OF HIGHLY COMPACTED WHOLE OYSTER SHELL IN EX. PAREN  
SOIL AVOID - AREA 71. F.S. No's: - 4. Photographs: GLOR P.L. # 112. Map Reference: 2 5. Strat. Record Reference: 13. Pages in Notes: Pt 1: 101-110, Pt 2: 34

Comments: THIS FEATURE WAS PHOTOGRAPHED & MAPPED. MEASURE  
MENTS GERT TAKEN OF THE BLOCKS. IT WAS LEFT IN SITU.

NO. 1 THRU 4 STARTING AT WESTERNMOST BLOCK	BLOCK	LENGTH	WIDTH	DEPTH
1	1	40 cm	38 cm	7.5 cm
2	2	49 cm	41 cm	9.0 cm
3	3	46 cm	37.5 cm	9.0 cm
4	4	56 cm	37 cm	12.5 cm

SKETCH

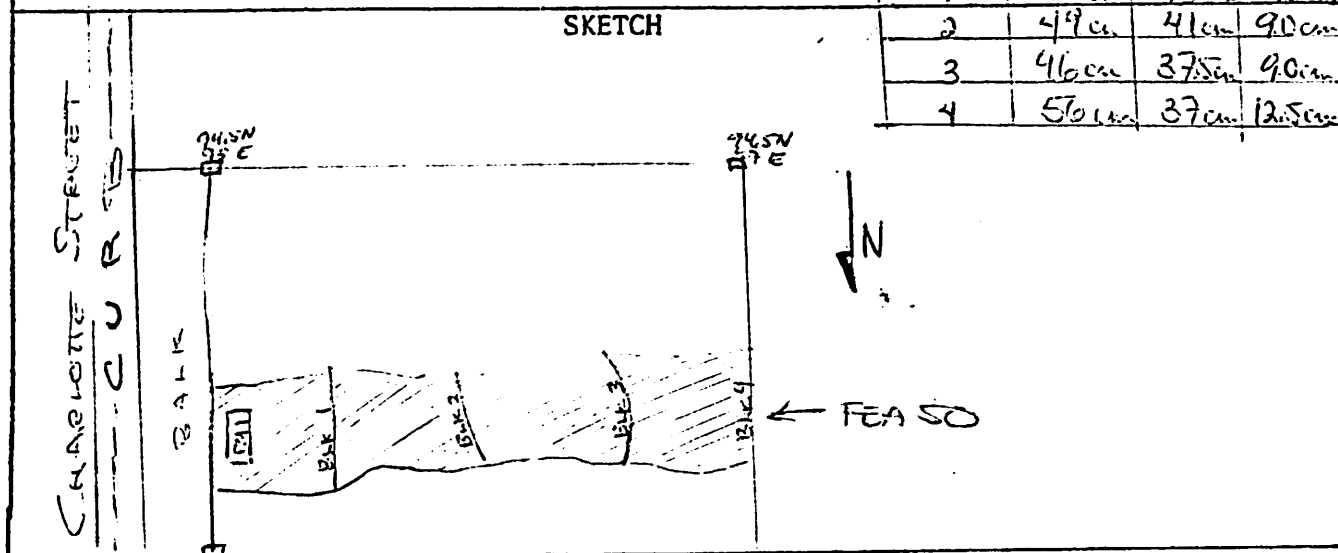

## FEATURE RECORD

F.S.U. St. Augustine Program

Site No. SA-26-1

Date MAY 29, 1979

Sheet 2 of

Feature No.: 51 Recorder Zierden

Excavation Units: Trench A Sec. 3

Depth from Surface: 46 cm

Depth from Datum: Top: 1.86  
Base:

Definition: Well construction pit has retained same shape & size for levels 1-

Matrix and Stratigraphy: mottled tan white & gray soil

Underlies: zone

In Matrix of: Zone 3 Zone 1

Intrudes into: Zone 2 Zone 3, sterile

Overlies:

1. F.S. No's: See back 4. Photographs: 3, 8, 4, 12  
2. Map Reference: 1, 7, 12 5. Strat. Record Reference: 2, 3  
3. Pages in Notes: (Pt. 2) 1-50

Comments: OK

### SKETCH

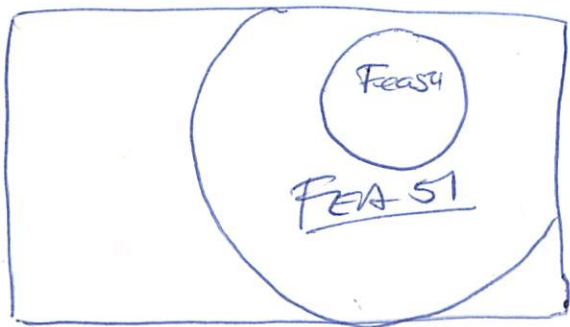

4

Level	Top	Base	FS
1	1.86	1.96	2.92
2	1.92	2.07	2.94
3	2.07	2.18	2.99
4	2.18	2.28	3.02
5	2.28	2.38	3.0
6	2.38	2.48	3.32
7	2.48	2.58	3.42
8	2.60	2.70	3.57
9	2.70	2.80	3.53
10	2.80	2.90	3.56
11	2.90	3.00	3.60

## FEATURE RECORD

F.S.U. St. Augustine Program

Site No. SA-26-1Date 5-31-77Sheet 6 of       Feature No.: 52 & 53 Recorder CABALLEROExcavation Units: TRENCH B SECTION 1Depth from Surface: 30cmDepth from Datum: Top: 1.70 (1st th)  
Base:       

Definition: 52 - BURNED WOODEN FLOOR - from house constructed after 1890. - covered most of ~~the~~ section 1

(53) - PIPE TRENCH - construction pit for iron pipe - ran E-W across section 1

## Matrix and Stratigraphy:

Underlies:

In Matrix of:

Intrudes into:

Overlies:

FEA 62concrete unit↓Zone 1FEA 63Fea 52Fea 52Zone 1

- |  |   |
|--|---|
| 1. F.S. No's: <u>      </u>            | 4. Photographs: <u>1, 2</u>               |
| 2. Map Reference: <u>      </u>        | 5. Strat. Record Reference: <u>      </u> |
| 3. Pages in Notes: <u>(PT) 145-146</u> |   |

Comments: NEITHER OF THESE FEATURES WERE SCREENED. THEY WERE NOTED & RECORDED.

SKETCH



F.S.U. St. Augustine Program

Site No. SA26-1  
Date may 29  
Sheet 1 of 6

 $\uparrow n$

Level	T	B	FS
1	0.27	0.37	309
2	0.37	0.47	333
3	0.47	0.57	340
4	0.57	0.70	350
5	0.70	0.80	352
6	0.79	0.89	354
7	2.89	2.99	398
8	0.99	3.08	359
9	3.08	3.19	361
10	3.19	<del>3.29</del> 3.37	362
below 10	3.37		363

## FEATURE RECORD

Site No. SA-26-1Date 5-31-79Sheet 5 of       

F.S.U. St. Augustine Program

Feature No.: 55 Recorder CABALLEROExcavation Units: TRENCH A SECTION 3Depth from Surface: 1.06 CMDepth from Datum: Top: 2.46  
Base: 2.80Definition: Originally defined as a Trench Pit - but probably the remains  
is unit of disturbance from Area 1 above.

## Matrix and Stratigraphy:

Underlies: Area 1

In Matrix of:

Intrudes into: SterileOverlies: Sterile

1. F.S. No's: 357
2. Map Reference: 9, 12
3. Pages in Notes: 10-149
4. Photographs: 12
5. Strat. Record Reference: 2, 3

## Comments:

## SKETCH

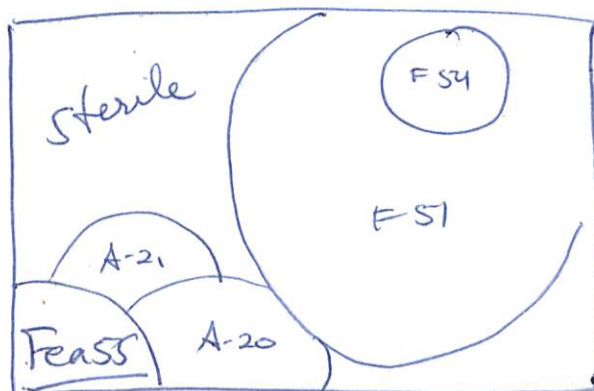



## FEATURE RECORD

F.S.U. St. Augustine Program

Site No. SA-26-1Date 5-31-79Sheet 4 of       Feature No.: 56 a+b Recorder CABALLEROExcavation Units: TRENCH B SECTION 1Depth from Surface: (56a) 45cm (56b) 54cm Depth from Datum: Top: <sup>56a-1.85</sup>56b-1.94  
Base: <sup>56a-2.29</sup>56b-2.54

Definition: FOOTINGS. 2 DISTINCT FOOTINGS WERE FIRST DEFINED AS DIFFERENT MANIFESTATIONS OF THE SAME THING & CALLED AREA 1 WHICH WAS RE-DESIGNATED FEA 56. THEN A DISTINCTION WAS MADE BETWEEN 56a & 56b. 56a: VERY COMPACT UNCLE CISTER & SOME CLAM IN TIME MORTAR COCCILIA BLOCKS. 56b: SAME COMPOSITION AS 'a' BUT CRUMBLY & LOOSE.

Matrix and Stratigraphy: 56a WAS PRESENT IN ZONE 1 ZONE 2 & BOTTOMED OUT IN ZONE 356b IS PRESENT IN ZONES 1, 2 & 3 & IS CONTINUING DOWNUnderlies: 56a: ZONE 1 & ZONE 2 56b: ZONE 1In Matrix of: Zone 2Intrudes into:       Overlies: 56a - Area 19 56b - Steile

1. F.S. No's: 56: 344
2. Map Reference: 56a: 8.11 56b: 8.11.14
3. Pages in Notes: (P42) 12-55
4. Photographs: 56a: 7 56b: 7, 12
5. Strat. Record Reference: 485

Comments: 56a & b WERE LUMPED INTO ONE CATEGORY - FEA 56 UNTIL 2.30 MBD WHEN 56a BOTTOMED OUT INTO AREA 19. 'a' & 'b' HAD BEEN CONSIDERED AS ONE PROVENIENCE IN FS # 344 WHICH WAS CLOSED OUT AT 2.27.4. 56b WILL BE SCREENED ON ITS OWN

## SKETCH

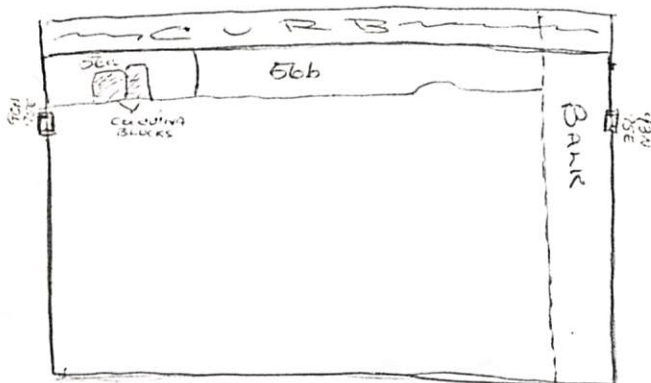



## FEATURE RECORD

F.S.U. St. Augustine Program

Site No. 20201Date 7/18Sheet 7 of 18Feature No.: 57 Recorder                     Excavation Units: TRENCH A Section 5Depth from Surface: 69 cmDepth from Datum: Top: 2.09  
Base:                     Definition: well construction pit - mottled sand  
surrounds Fea 62 (well)Matrix and Stratigraphy: Zone 1Underlies:                     In Matrix of: sterile soilIntrudes into: sterile soilOverlies:                     1. F.S. No's: see below4. Photographs: 19, 20, 232. Map Reference: 17,5. Strat. Record Reference # 6473. Pages in Notes: 75, 82

Comments:

at 3.15 m below the top of the water barrel appeared (in L-4) about this level the barrel was broken & its outline dimensions construction pit bottom, barrel detail on opposite side against self at                      level

F.S.'s - levels

SKETCH

1 -	} combined with other Feas.		
2 -			
3 -			
4 -	2.47	2.54	3.99
5 -	2.54	2.64	4.03
6 - WY2	2.67	2.77	4.21
7 - WY2	2.77	2.95	4.24
8 - WY2	2.95	3.10	4.26
9 - WY2	3.10	3.25	4.27
10 - "	↖ LAST LEVEL		
11 - "			
12 - "			
13 - "			

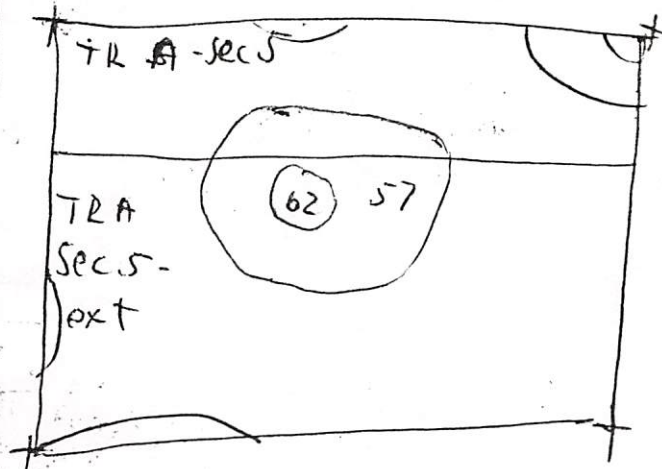

Feature No.: 58 Recorder HERRONExcavation Units: TRENCH CDepth from Surface: — 1.70Depth from Datum: Top: 1.70  
Base: 2.20

Definition: SEMI-CIRCULAR AREA IN WEST END OF □ ADJACENT  
TO BALK. DARK BLACK-BROWN SOIL WITH HEAVY CONCENTRATIONS  
OF SHELL, BONE + CHARCOAL.

Matrix and Stratigraphy: MATRIX-ZONE 1, LEVEL 1Underlies: BEGINS AT TOP OF □In Matrix of: ZONE 1, LEVEL 1Intrudes into: ZONE 1, LEVELS 1, 2, & 3Overlies: AREAS 8, 9, 23 + FEATURE 671. F.S. No's: 4534. Photographs: 2, 42. Map Reference: 25. Strat. Record Reference: 33. Pages in Notes: 27, 28

Comments: appears to be a 19<sup>th</sup> century garbage pit. Also -  
contains concentrations of orange clay w/ much charcoal  
(see photo 4)

## SKETCH

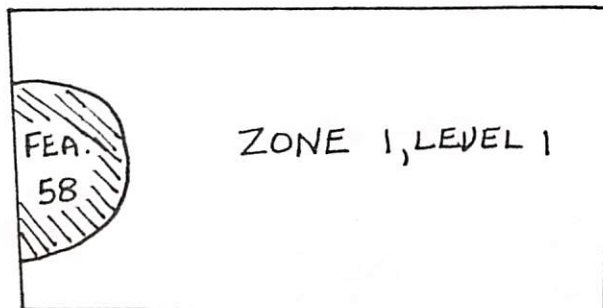

Feature No.: 59 Recorder HERRONExcavation Units: TRENCH CDepth from Surface: .28MDepth from Datum: Top: 1.98  
Base: 2.24Definition: DARK BROWN SOIL WITH A HEAVY CONCENTRATION OF  
RUBBLE, SHELL + BONE. EXTENDS RAUGHLY N to S  
ACROSS IT.Matrix and Stratigraphy: ADJACENT TO AREAS 2,3,+4 in ZONE 1,  
LEVEL 3Underlies: ZONE 1, LEVEL 2In Matrix of: ZONE 1, LEVEL 3Intrudes into: ZONE 1, LEVEL 3Overlies: AREA 151. F.S. No's: 452 4. Photographs: 32. Map Reference: 3 5. Strat. Record Reference: -3. Pages in Notes: 28

Comments: \_\_\_\_\_

\_\_\_\_\_

\_\_\_\_\_

## SKETCH

TOP OF  
ZONE 1, LEVEL 3

FEA. 59





## FEATURE RECORD

F.S.U. St. Augustine Program

Site No. SA-26-1Date 7-12-79Sheet 9 of 18Feature No.: 60 Recorder CaballeroExcavation Units: TR A SECT EXTENSIONDepth from Surface: 1.29 cmDepth from Datum: Top: 2.69  
Base: 3.16WELL

Definition: CIRCULAR, GOING INTO N.E. CORNER OF SQUARE. DARK GREY-BLACK SHEL FLECKED W/ SOME TAN WASH. - ~~IT~~ LOOKED LIKE WELL AT FIRST, THIS WAS CHANGED TO TRASH PIT & CHANGED BACK TO WELL WHEN EXCAVATED FINDING FEA 66, THE WELL ITSELF WITHIN IT. WERE NOT ABLE TO RECOVER MUCH, AS THE WATER TABLE ROSE.

Matrix and Stratigraphy: ~~STERILE~~ ~~SOIL~~Underlies: ZONE 1In Matrix of: STERILE SOILIntrudes into: FEA 57, FEA 61Overlies: STERILE

1. F.S. No's: 377, ~~378~~, 401, 405, 407, 410, 411 4. Photographs: PL# 18 & 20  
416,
2. Map Reference: 18, 19 5. Strat. Record Reference: 647
3. Pages in Notes: 83 - 100

Comments: \_\_\_\_\_  
\_\_\_\_\_  
\_\_\_\_\_

## SKETCH

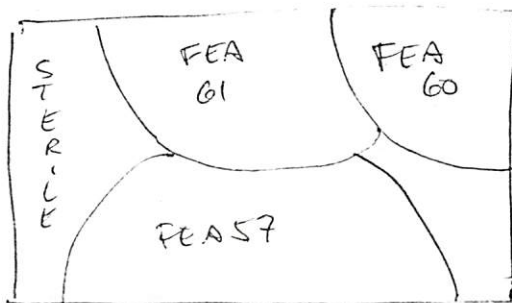



## FEATURE RECORD

F.S.U. St. Augustine Program

Site No. SA-26-1Date 7-12-79Sheet 9 of 18Feature No.: 61 Recorder CaballeroExcavation Units: TR A SEC 5 + EXTENSIONDepth from Surface: 1.28cmDepth from Datum: Top: 2.68  
Base: 2.99

Definition: BROWN - GROUND - GREY MOTTLED & WASHY SANDY  
SOIL IN CIRCULAR SHAPE, WELL-LIKE CONFIGURATION, BUT  
BOTTOMED OUT QUICKLY & DID NOT RETAIN FORMER SEMI-CIRCULAR  
SHAPE.

## Matrix and Stratigraphy:

Underlies: ZONE 1In Matrix of: STERILEIntrudes into: FEA 57Overlies: STERILE

1. F.S. No's: <sup>398, 402, 404</sup>402, 408 4. Photographs: PL# 18, 20  
2. Map Reference: 18, 19 5. Strat. Record Reference: 677  
3. Pages in Notes: 83 - 96

Comments: \_\_\_\_\_  
\_\_\_\_\_  
\_\_\_\_\_

## SKETCH

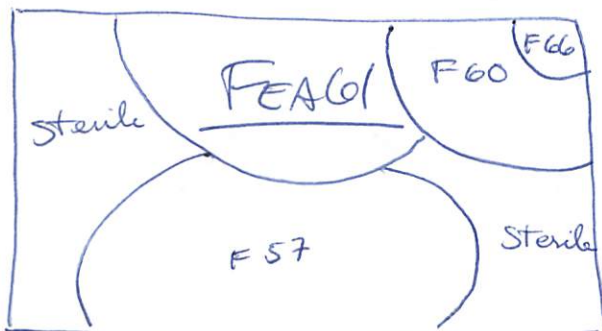

## FEATURE RECORD

F.S.U. St. Augustine Program

Site No. SA-26-1Date 7-11-79Sheet 10 of 25Feature No.: 62 Recorder DeaganExcavation Units: Trench A, Sec 5 + it's extensionDepth from Surface: 1.13 cmDepth from Datum: Top: 2.74  
Base:         Definition: barrel well,  
at level 1 (mbd) is a series of concentric  
rings (see below)

## Matrix and Stratigraphy:

Underlies: zone 2In Matrix of: Fea 57Intrudes into: Fea 57Overlies:         1. F.S. No's: see below 4. Photographs: 20, 22, 232. Map Reference: 19, 20 5. Strat. Record Reference: 193. Pages in Notes: 99-102 687Comments: at 7.15 the barrel (stone) appear in site - above 46.10  
level the barrel had pitted & irregularities - at 3.15 barrel  
diameter iscombined  
after  
L-1

level 1	a) - 274	284	420
	b) - "	"	414
	c) - "	"	418

level 2	- 284 - 295 -	423
L 3	- 295 - 3.10	425
L 4	- 3.10 - 3.26	428
L 5	- 3.26 -	429

L 6  
L 7  
L 8  
L 9  
L 10

SKETCH

all Fea 62, L-1  
solid block, L-2 is later



## FEATURE RECORD

F.S.U. St. Augustine Program

Site No. SA-26-1Date 7-12-79Sheet 11 of 15Feature No.: 63 Recorder CABALLEROExcavation Units: TRA SECS + EXTENSIONDepth from Surface: 1.13CMDepth from Datum: Top: 2.53  
Base: 2.90

Definition: SEMI CIRCULAR, WASHY AROUND EDGES, OTHERWISE OF  
MEDIUM GREY SHELL FLECKED SOIL. THIS COLOR SOIL KOTTONED  
OUT ONTO A NEW COLOR SOIL ZONE 2 WHICH WAS POOR CULTURAL  
MATERIAL

Matrix and Stratigraphy: — EXPOSED BY BACKHOE PROCESS

Underlies: \_\_\_\_\_

In Matrix of: STERILEIntrudes into: STERILEOverlies: STERILE1. F.S. No's: 413, 415, 4194. Photographs: PLT 202. Map Reference: 195. Strat. Record Reference: —3. Pages in Notes: 92-101687

Comments: \_\_\_\_\_

\_\_\_\_\_

\_\_\_\_\_

## SKETCH

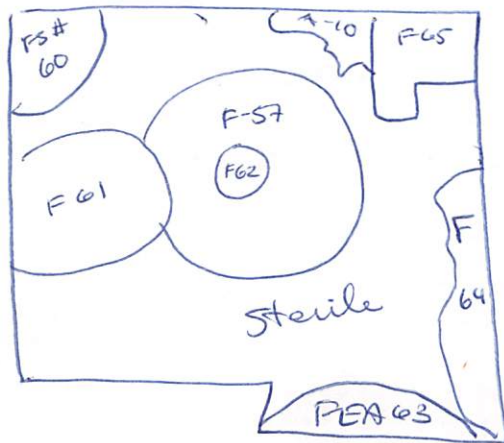

F.S.U. St. Augustine Program

Sheet 17 of 19

[illegible]



## FEATURE RECORD

F.S.U. St. Augustine Program

Site No. SA-26-1

Date 7-12-79

Sheet 13 of 15

Feature No.: 65 Recorder CARAWAY

Excavation Units: TE A Sec 5 + EXTENSION

Depth from Surface: 1.20 CM

Depth from Datum: Top: 2.60  
Base: 1.60

Definition: CORNER FOOTINGS OF COQUINA BLOCKS ENCLOSING  
 DK GRAY-BROWN SOIL FLECKED SIL. X POSSIBLE BUILDERS  
 TRENCH EXTENDS DIAGONALLY FROM THE CORNER. Judging from  
 the material recovered while profiling, the soil enclosed by the coquina  
 can be defined as a late 19th C. trash pit.

Matrix and Stratigraphy: EXPOSED BY BACKHOE PROCESS

Underlies:

In Matrix of: ?

Intrudes into: ?

Overlies: ?

1. F.S. No's: 432 (S. Profile of TE A Sec 5 + Ext)
2. Map Reference: 19
3. Pages in Notes: 920
4. Photographs: PL # 20
5. Strat. Record Reference: 7

Comments: NOT EXCAVATED - In the process of cleaning  
 up S Profile, Fea 65 had to be cut back considerably - much  
 cultural material was recovered in this manner & bagged as  
 FE 65 Profile

## SKETCH

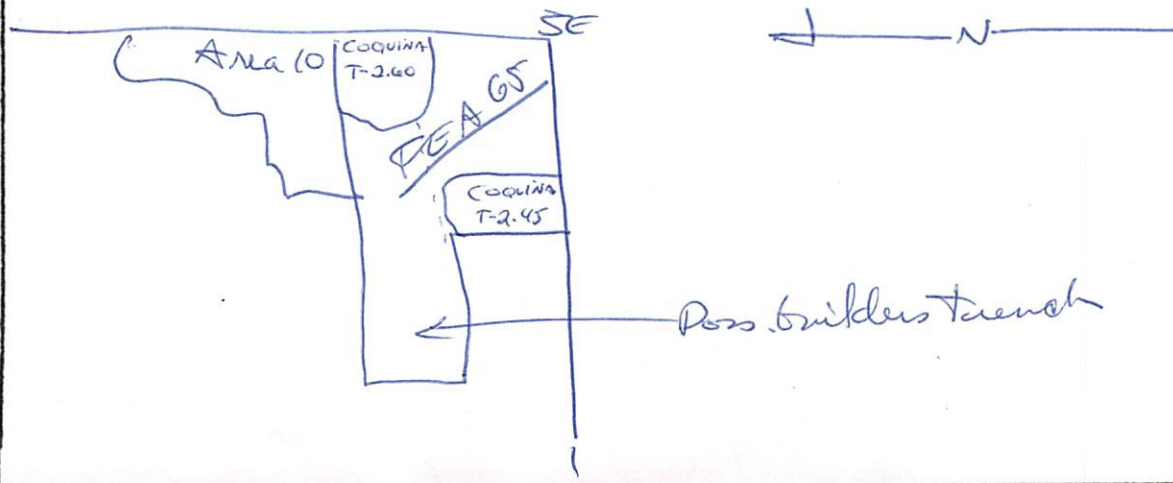

## FEATURE RECORD

F.S.U. St. Augustine Program

Site No. SA-26-1Date 7-12-77Sheet 14 of 18Feature No.: 66 Recorder CaballeroExcavation Units: TRENCH A SECS + EXTENSIONDepth from Surface: 1.46 CMDepth from Datum: Top: 3.06  
Base:       Definition: BLK-BRN COMPACT SOIL - WELL FOUND WITHIN  
FEA 60 WHICH HAD BEEN DEFINED AS A TRASH PIT.  
MATERIAL RECOVERED INDICATES 10% (C) CONTENT.

## Matrix and Stratigraphy:

Underlies:       In Matrix of: FEA 60Intrudes into: ↓Overlies: ?

1. F.S. No's: 412, 430, 417 (Soil Sample)
2. Map Reference: 20
3. Pages in Notes: 97-105
4. Photographs: 20
5. Strat. Record Reference: 637

Comments: ONLY A 1/4 OF FEA 66 WAS PRESENT IN THIS UNIT. 1 LAYER  
WAS REMOVED & WATER SEEPED IN <sup>EXC. UNIT</sup> AFTER EXCAVATION OF FEA 62  
TRITION WAS TURNED BACK TO THIS FEA & AN EFFORT WAS MADE TO  
RECOVER AS MUCH MATERIAL AS POSSIBLE - THIS WAS BEGON AS

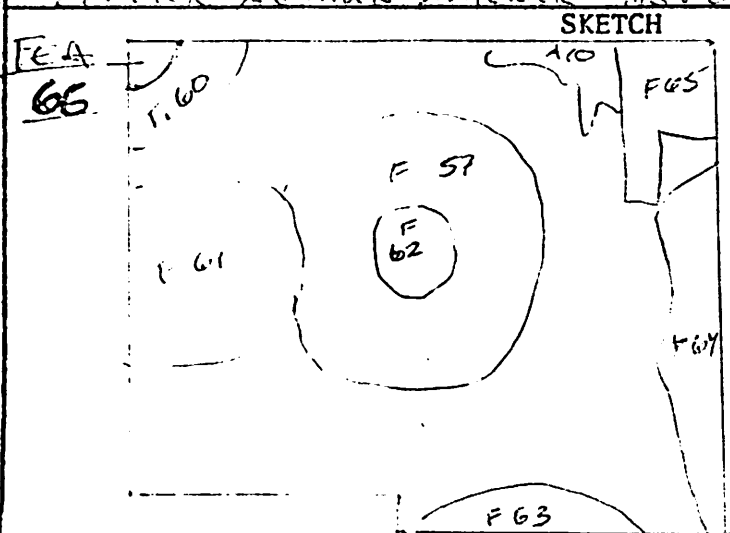

FEA 66 - LEV 2

	A	B	F.S.
LEV 1	3.06	3.16	412
LEV 2	3.16	→	430

Soil Sample at 3.16 <sup>F.S.</sup> # 417

Feature No.: 67 Recorder HERRONExcavation Units: TRENCH CDepth from Surface: .66MDepth from Datum: Top: 2.36  
Base: 2.63Definition: DARK GRAY-BLACK SOIL WITH HEAVY  
CONCENTRATIONS OF SHELL-BONE-CHARCOAL.  
COVERS W/END OF □.Matrix and Stratigraphy: INTRUDES INTO STERILEUnderlies: AREAS 8, 9, & 23In Matrix of: STERILEIntrudes into: STERILEOverlies: STERILE1. F.S. No's: 479 4. Photographs: 20, 21, 312. Map Reference: 9, 15 5. Strat. Record Reference: 33. Pages in Notes: 33, 34

Comments: \_\_\_\_\_

## SKETCH

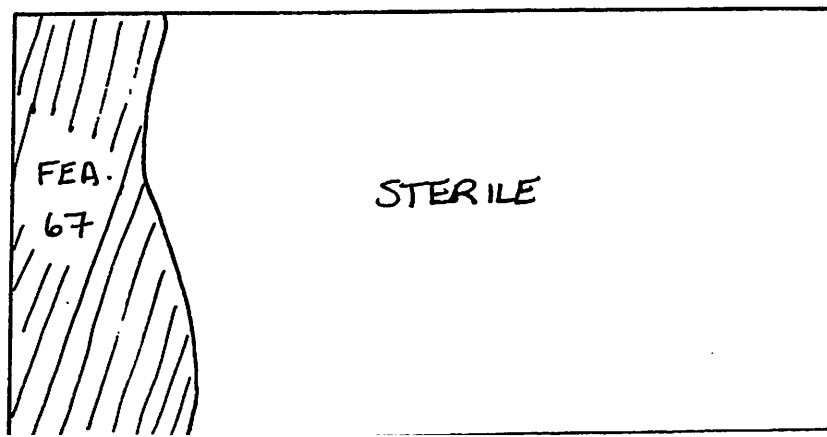

## FEATURE RECORD

F.S.U. St. Augustine Program

Site No. SA 26-1Date July 19Sheet 150 of 16Feature No.: 68 Recorder ZierdenExcavation Units: Trench A Sec. 7Depth from Surface: 1.09 cmDepth from Datum: Top: 2.49  
Base: unex.Definition: Well construction pit - circular feature of mottled  
gold, white, & gray-brown soil. - associated w/ Fea 69 & 70

## Matrix and Stratigraphy:

Underlies: unexcavated

In Matrix of: -

Intrudes into: Sterile

Overlies:

1. F.S. No's: 497
2. Map Reference: #21, 22.
3. Pages in Notes: 106-131
4. Photographs: 26, 27, 28
5. Strat. Record Reference: #8

Comments: only the western 1/3 of the edge is present in  
the square, the other sides intruding into the north,  
west, and south edge of the pit - ONLY 1 LEVEL  
WAS EXCAVATED

## SKETCH





Level 1		2.57	
B		2.73	
FS#		497	

## FEATURE RECORD

F.S.U. St. Augustine Program

Site No. SA 26-1

Date July 19

Sheet 16 of 18

Feature No.: 69 Recorder Zierden

Excavation Units: Trench A Sec. 7

Depth from Surface: 1.15 cm

Depth from Datum: Top: 2.55  
Base: unex

Definition: 4 interlocking coquina walls to form a square well. FOR MEASUREMENTS SEE BACK  
THREE COURSES OF COQUINA BLOCKS WERE NOTED WHILE EX. FEA 70. THERE WAS NO EVIDENCE OF ANY MORTAR BETWEEN BLOCKS, THEY WERE ALL UNIFORM IN SIZE.

Matrix and Stratigraphy:

Underlies: ? - unexcavated

In Matrix of: sterile

Intrudes into: Fea. 68

Overlies:

1. F.S. No's: NONE
2. Map Reference: 22
3. Pages in Notes: 120-131
4. Photographs: 26, 27, 28
5. Strat. Record Reference: 8

Comments: 12 blocks in all were noted after reaching sterile sand at 34 cm. FEA 70/6. ~~THE THIRD COURSE OF BLOCKS~~ <sup>BASE OF</sup> ~~FEA 70/6~~ <sup>FEA 70/6</sup> ~~WAS NOT REACHED & A POSSIBLE 4th COURSE OF BLOCKS~~ <sup>WAS NOT REACHED & A POSSIBLE 4th COURSE OF BLOCKS</sup> ~~SEE ALSO FROGABLE.~~ SKETCH

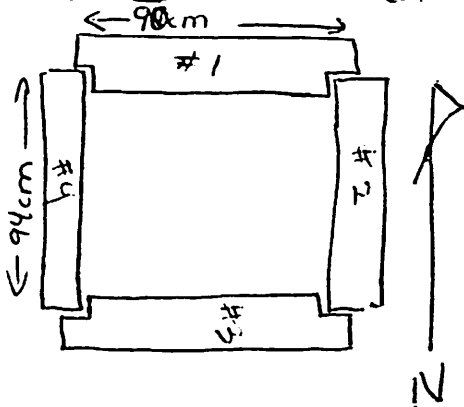

FEB 69

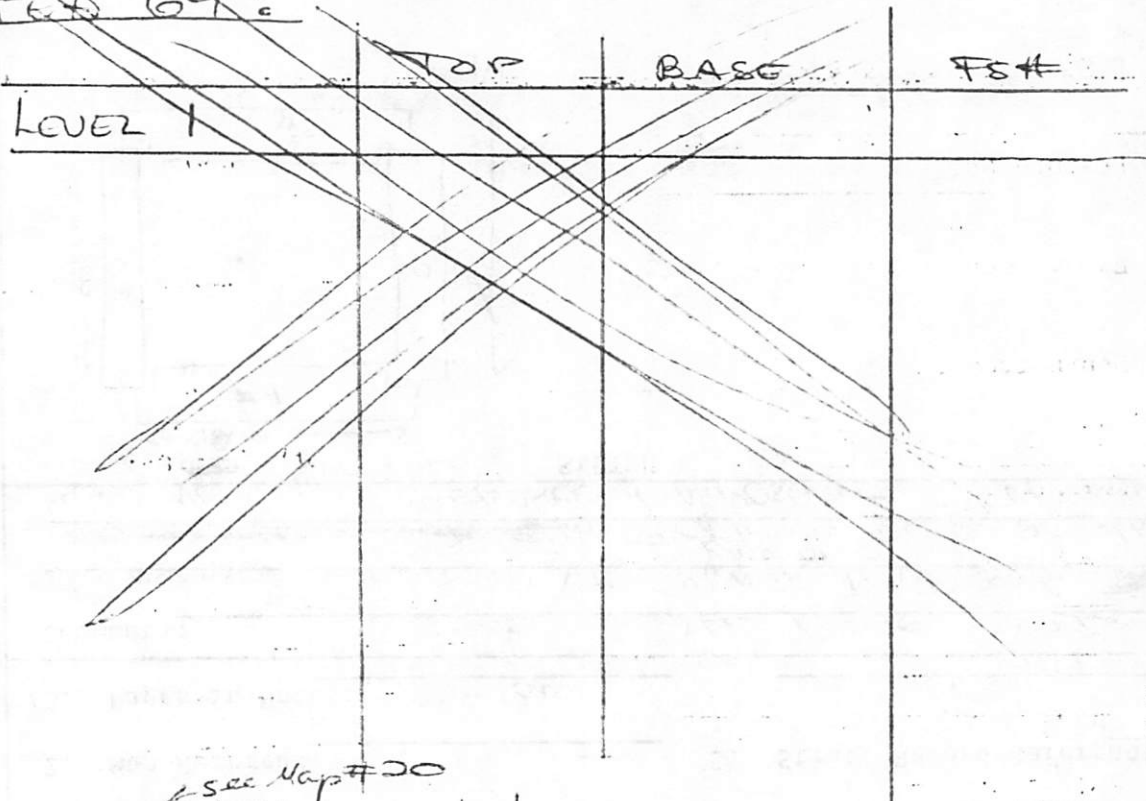

see Map #20

BLOCK #	LENGTH	WIDTH
1	90cm	16cm
2	94cm	14cm
3	95cm	19cm
4	94cm	19cm

	TOP	BASE	THICKNESSES
1st Course of Block	2.55	2.84	29cm
2nd Course	2.82	3.18	31cm
3rd Course	3.14	3.48	34cm +

## FEATURE RECORD

F.S.U. St. Augustine Program

Site No. SA 26-1  
Date July 19  
Sheet 17 of 18Feature No.: 70 Recorder ZierdenExcavation Units: Trench A Sec. 7Depth from Surface: 1.18 CMDepth from Datum: Top: 2.58  
Base: 3.98

Definition: well - fill inside of Fea 64, coquina walls  
mottled medium & dark gray soil with crushed shell  
fllecking  
- level 2 - changes to black organic muck directly  
below level of planter.

Matrix and Stratigraphy:

Underlies: U40xIn Matrix of: sterileIntrudes into: Fea. 68 & 69Overlies: Sterile.

- |                                   |                                      |
|-----------------------------------|--------------------------------------|
| 1. F.S. No's: <u>See back →</u>   | 4. Photographs: <u>26</u>            |
| 2. Map Reference: <u>22</u>       | 5. Strat. Record Reference: <u>8</u> |
| 3. Pages in Notes: <u>120-121</u> |                                      |

Comments: 6 LEVELS OF 15 CM EACH WERE EXCAVATED.  
AT 3.48 STERILE SAND WAS ENCOUNTERED.

## SKETCH

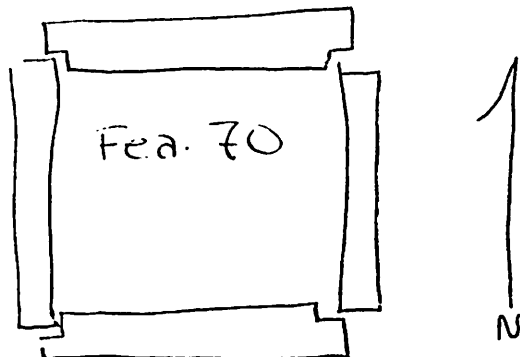



	TOP	BASE	FS
Level 1	2.55	2.72	494
Level 2	2.71	2.87	496
Level 3	2.87	3.02	498
Level 4 <sup>1st</sup> (1/2)	3.02	3.09	499
Level 4 <sup>2nd</sup> (1/2) <sup>UN-SECT</sup>	3.09	3.16	500
Level 5 <sup>1st</sup> (1/2)	3.16	3.25	503
Level 5 <sup>2nd</sup> (1/2) <sup>UN-SECT</sup>	3.25	3.31	502
Level 6 <sup>1st</sup> (1/2)	3.31	3.48	504

Strife Sand was accounted

See Feature 69 Record

	T	B	Width
COQUINA BLOCK #1			29cm
" " #2	27cm BL	58cm BL	31cm

## FEATURE RECORD

F.S.U. St. Augustine Program

Site No. SA-26-1Date 8-2-79Sheet 18 of 211Feature No.: 71 Recorder CaballeroExcavation Units: Th A Sec 7Depth from Surface: 1.33 CMDepth from Datum: Top: 2.73  
Base: 2.88

Definition: BARREL WELL ADJACENT TO EASTERN EDGE OF  
COQUINA WELL (FEA 70) DARK GREY-BLACK-BROWN LOOSLY  
COMPACTED SHELL FLECKED SOIL SURROUNDED BY WASHY LIGHT GREY  
CLAY MOTTLED SOIL

## Matrix and Stratigraphy:

Underlies: FEA 68In Matrix of: FEA 68Intrudes into: FEA 68Overlies: FEA 68

1. F.S. No's: 501
2. Map Reference: 22
3. Pages in Notes: 129-131
4. Photographs: NONE
5. Strat. Record Reference: 8

Comments: THIS FEATURE APPEARED AFTER REMOVING FEA 68 LEVEL  
AFTER REMOVING THE 1ST LEVEL (15CM) OF THIS FEATURE IT  
EXTENDED OUT INTO THE WASHY SOIL OF FEA 68

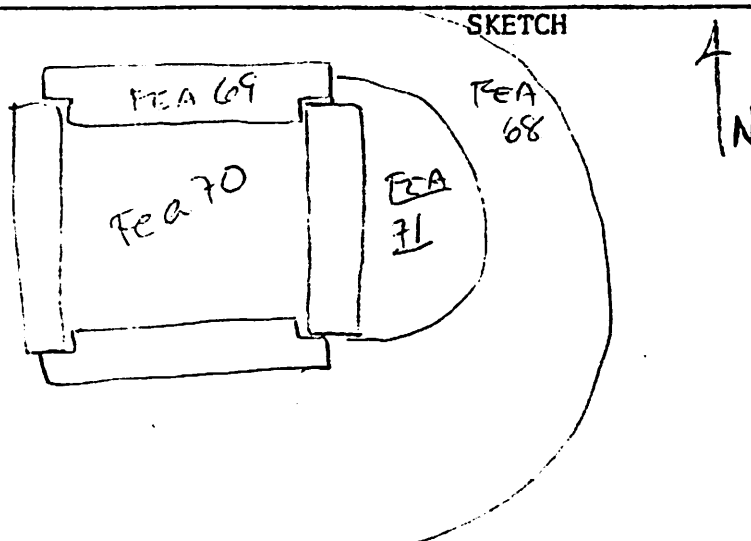

	T	B	FS
Level 1	273	288	501